

Rain Check Workshops



What is Rain Check?

Rain Check helps Philadelphia residents pay for special landscaping tools that improve the environment and beautify their homes. Rain Check supports Philadelphia's Green City, Clean Waters program which is working in neighborhoods across the City, adding green features to keep excess stormwater out of sewers.

Can I host a Rain Check Workshop?

PWD & PHS partner with civic associations and community groups throughout Philadelphia to host Rain Check Workshops. All participants are required to attend a workshop. Below are our criteria for hosting a workshop:



- All Rain Check workshops must be open to the public. We do not offer private workshops restricted to one civic group or neighborhood.
- You are willing to help advertise the workshop in your community.
- You can provide a venue large enough to host 50 – 100 people.
- You can ensure that a minimum of 30 people register for a workshop.
- Your venue is available for early evening workshops (usually 6:00 – 7:00 pm).
- Venues with a parking lot or on-street parking are preferred.

To schedule a workshop in your community, please contact **Rosemary Howard** at PHS (rhoward@pennhort.org or 215.988.8767)

What is stormwater runoff?

Stormwater runoff is rain water that doesn't soak into the ground. Instead, it runs off hard surfaces in the city, like roofs and streets and into our sewer system. Stormwater runoff carries pollution and can cause many problems for Philadelphia's rivers and streams. The Stormwater Tools offered through Rain Check can help keep our rivers clean.

What tools are available through Rain Check?

There are five tools available through Rain Check: rain barrels, downspout planters, rain gardens, depaving and permeable pavers. Through the program, rain barrels are installed at your home for free, and all the other tools have significantly lower costs.

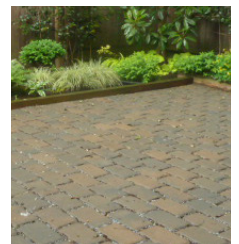
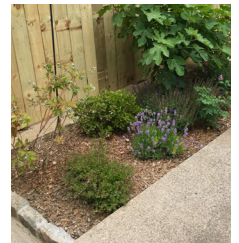

visit www.pwdraincheck.org



A Philadelphia Water Department program.
Managed by the Pennsylvania Horticultural Society in partnership with the Sustainable Business Network.